



CLASH AND VALIDATE BUILDING DESIGNS

Verifi3D
by Xinaps

The Workflow

A typical project contains a vast amount of information that is made up of multiple file formats and disconnected processes that quickly become out of sync when changes are made. The information in the model is evolving during each phase of the project. This impacts almost every facet of the project, from initial discussion to design and construction up until the handing over of the keys to the owners or the facility managers.

Verifi3D's workflow supports a more dynamic and synchronized approach based on User Access Roles: Company Administrators, Project Administrators and General Users enabling streamlined and informed decision-making. To start model checking, users can import models (locally or from CDEs) and combine them into Model Sets. By creating customizable Filters and Filter Sets, they can organize and classify building data. Rules and Rule Sets help automating the checking process. In addition, Verifi3D Exchange (a community-driven platform), allows users to download project templates to share, amend and take into other projects.

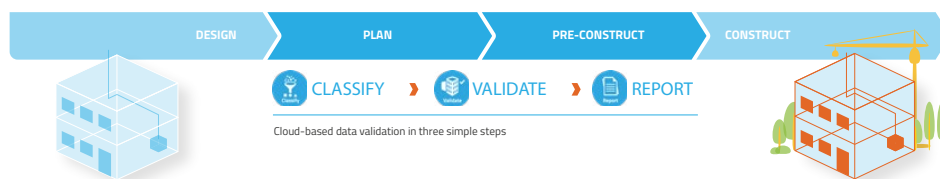

The Challenge

In any construction or engineering project, multiple workflows are happening at once. This can result in inconsistent building data - an industry and a global environmental problem. And it carries a hefty price tag. Left unaddressed, it can cause scalability issues, revenue loss, inaccurate project prioritization, rework and a higher carbon footprint. Data can make a difference, especially in design and early construction. A universal solution supporting workflows from design to the pre-construction stage is necessary to create high-quality building files.

[Watch the video](#)

The Solution

Verifi3D bridges the gap between design and early construction. It tackles many of the issues by providing teams with enhanced model coordination, automated clash detection and geometric checking with an advanced rule-based engine for less manual work. It is browser-based for simple collaboration and better coordination between teams.

Verifi3D supports Revit and IFC files, eliminating the need for converting and transferring files without losing data. It is integrated with Common Data Environments (CDEs), such as Autodesk Construction Cloud, Autodesk BIM 360, Dropbox and issue trackers, such as BIM Track, BIMcollab and Autodesk BIM 360 Issues. Users can create and export issue reports as BCF file.

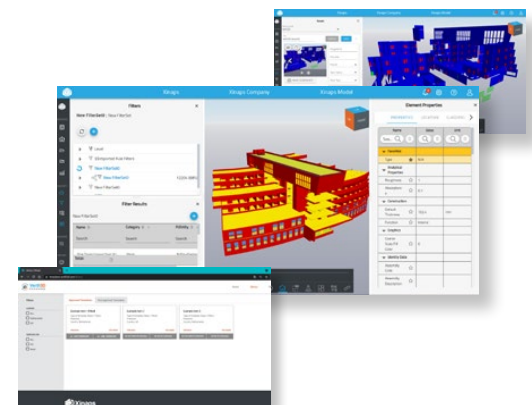

The Result

Verifi3D streamlines your model-checking process by simplifying and optimizing your existing workflow through its advanced rule-based engine, 3rd party integrations and cloud-based structure. As a result, users can improve profit margins, reduce rework and carbon footprint. Put an end to inconsistent data through the automated clash and geometric checks and make your process more efficient and error-proof.

According to our customers

up to
14x more effective workflow and less time spent on rework compared to other industry solutions.

40% of miscalculations and mistakes can be avoided by using tools like Verifi3D.

➤ **User-friendly interface:** No training and no consultancy required.

CHARACTERISTICS

Functionalities:



Custom Rule Sets: Create, import, and export custom rule sets. **Save and reuse them** for other models.



Real-time sync: Run the software on a **web browser**, without any installations. **Live sync** with project CDE's. Upload, check files in real-time and share with other project participants.



Data validation: Use **templates** to ensure that the model information is in accordance with **project requirements**.



Reporting: Report issues to **issue trackers** such as Autodesk BIM 360 Issues, BIMCollab, BIM Track or via a **BCF file**.



Soft clash detection: Using discipline-based models, quickly check for any potential issues prior to construction and highlight them with a **section box**. Perform geometric checks.



Quantities: Create Filters and FilterSets, take them into **quantity takeoffs** and export them into Excel files.

Integrated with:

Common Data Environments



Have a single source of truth for all your project data. Ensure a seamless flow of information real-time.

Issue Trackers



Make data driven decisions. Identify, track, report and assign issues real-time and create better models.

Project Management



Integrate data at the project level. Visualize your construction data and turn data into actionable insights.

Available on App Center:



Choose your plan:

| Free | Verifi3D Per Seat | Verifi3D Enterprise | Verifi3D by Xinaps + Dropbox Bundle |
|---|---|---|--|
| 14-Day Trial <ul style="list-style-type: none"> Unlimited BIM models E-learning Support Request a trial | <ul style="list-style-type: none"> Floating license Unlimited BIM models E-learning Support Online training Integrations with CDEs* and Issue Trackers** Get a proposal | <ul style="list-style-type: none"> Everything on Per Seat API Integrations Power BI Consultancy services Contact us | <ul style="list-style-type: none"> Includes 1 Dropbox Professional account Floating license Get a proposal |

* Autodesk BIM 360, Autodesk Construction Cloud, Dropbox

** BIM Track, BIMcollab, Autodesk BIM 360 Issues

Trusted by:





About Xinaps

Excellence by technology: We believe in building better.

We are the developer of Verifi3D, the cloud-based (SaaS) solution for building design validation. Verifi3D bridges the gap between the design and the construction stage. With Verifi3D, user can automate checks with our advanced rule-based engine. Optimize cost, minimize the need for rework, and improve the quality of building data thus reducing waste.

It is our mission to lead the transformation and digitalization of the AEC industry.

We believe in building better!

Our partners



evolveconsultancy



Where to find us



verifi3d.com



xinaps.com



[Xinapssoftware](https://www.facebook.com/Xinapssoftware)



[xinaps](https://www.linkedin.com/company/xinaps)



[_xinaps](https://twitter.com/_xinaps)



[_xinaps](https://www.instagram.com/_xinaps)